



PRODUCT DATA SHEET

MX50P-1HD - 2" DIGITAL FLOW METER WITH PR DISPLAY

The MX Series 2" DIGITAL FLOW METER are suitable for flows between 15 – 500 L/min (3.96 - 132.09 GPM), providing highly accurate flow measurement performance. The MX Series offers $\pm 0.5\%$ accuracy of true reading in a compact footprint, requiring no flow conditioning and with high pressure and temperature capabilities.

Key features include:

- Stainless Steel (316) construction
- FEP Encapsulated seals
- Maximum flow rate 500 L/min / 132.09 GPM
- Accuracy of $\pm 0.5\%$ of reading
- Exceptional repeatability of $\pm 0.03\%$
- Temperature up to 80 °C / 176 °F
- 1 point factory calibration as standard, with additional points upon request



P: 03 5956 8685 M: 0488 029 256

Email: sales@besflowmeters.com.au

SPECIFICATIONS



MX50P-1HD

		MX50P-1HD		
Material of construction	Meter Body	Stainless Steel (316)		
	Rotor	PPS		
	Seals	FEP Encapsulated		
Design Specifications				
Process Connections		2" G Thread		
Technical Specifications		min	max	
	Flow rate			
	< 5cPr	15	500	L/min
		3.96	132.09	GPM
	> 5cP	15	500	L/min
		3.96	132.09	GPM
	Non lubricating fluids	-	500	L/min
		-	132.09	GPM
Operating Temperature Range**		-40	80	°C
		-40	176	°F
	Accuracy ($\pm\%$)	$\pm 0.5\%$		
	Repeatability ($\pm\%$)	$\pm 0.03\%$		
	Nominal K-Factor	6.7 Pulses/Litre		
		25.37 Pulses/Gallon		

OUTPUT TYPE



PR DISPLAY

		PR [LCD 12mm display]
Construction		Polypropylene
IP Rating		IP67
Temp		Min: -20 Max: 60 °C Min: -4 Max: 140 °F
EX Approvals		- Please refer to instruction manual and certification documentation for product appropriate certification information
Display	Digit size (upper/lower)	12mm/8mm
	Accumulated total	✓
	Resettable total	✓
	Preset total	✗
Outputs	Flow rate	✓
	4-20 mA (passive)	✗
	Pulse/Transistor Output	✗
	Flow Alarm	✗
	Batch Control output	✗



macnaught

PRODUCT DATA SHEET

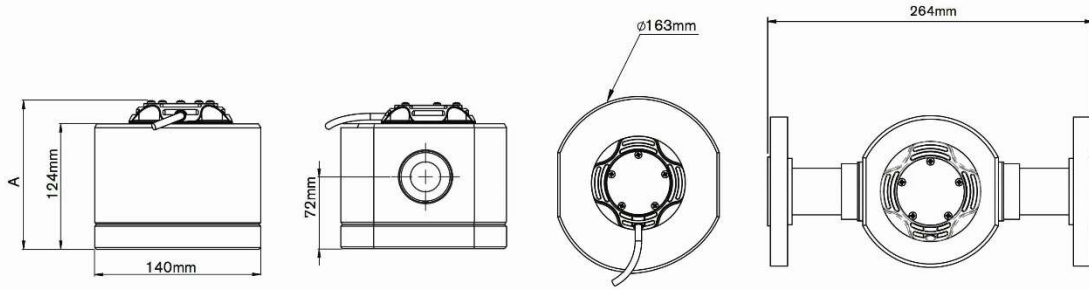

PULSER AND DISPLAY HEIGHT - A

OUTPUT A,I,J,K
PULSER - Standard

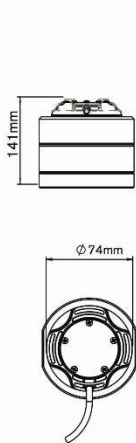

OUTPUT B
PULSER - Exia

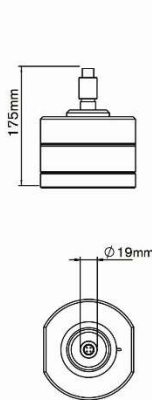

OUTPUT C
PULSER - EXd

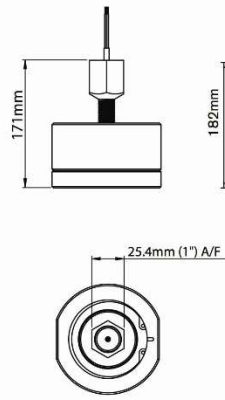

OUTPUT N
PULSER - Exia

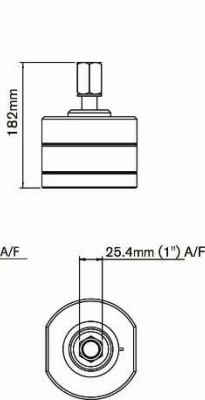

OUTPUT T
PULSER - High Temp.

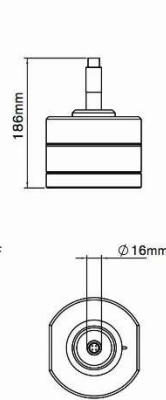

OUTPUT D,E
DISPLAY - LCD 12mm

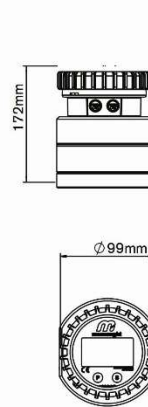

OUTPUT F,G,H DISPLAY
- LCD 17mm

