



# PRODUCT DATA SHEET

## WM80AAP-3C9 - 3" CUSTODY TRANSFERMETER WITH PULSE OUTPUT

The WM Series 3" CUSTODY TRANSFERMETER are suitable for flows between 140 – 700 L/min (36.98 - 184.92 GPM), providing highly accurate flow measurement performance. The WM Series offers  $\pm 0.50\%$  accuracy of true reading in a compact footprint, requiring no flow conditioning and with high pressure and temperature capabilities.

### Key features include:

- Cast Aluminium construction
- FKM (Viton) seals
- Maximum flow rate 700 L/min / 184.92 GPM
- Accuracy of  $\pm 0.50\%$  of reading
- Exceptional repeatability of  $\pm 0.03\%$
- Temperature up to 120 °C / 248 °F
- 1 point factory calibration as standard, with additional points upon request



P: 03 5956 8685 M: 0488 029 256  
Email: sales@besflowmeters.com.au

### SPECIFICATIONS



WM80AAP-3C9

		WM80AAP-3C9		
Material of construction	Meter Body	Cast Aluminium		
	Rotor	Aluminium (6061)		
	Seals	FKM (Viton)		
Design Specifications				
Process Connections		3" ANSI Flange		
Technical Specifications		min	max	
	Flow rate	140	700	L/min
	< 5cPr	36.98	184.92	GPM
	> 5cP	140	700	L/min
		36.98	184.92	GPM
	Non lubricating fluids	-	700	L/min
		-	184.92	GPM
Operating Temperature Range**		-40	120	°C
		-40	248	°F
	Accuracy ( $\pm\%$ )	0.50%		
	Repeatability ( $\pm\%$ )	0.03%		
	Nominal K-Factor	2.58 Pulses/Litre		
		9.77 Pulses/Gallon		

### OUTPUT TYPE

#### PULSE OUTPUT

		Reed/Reed
Construction	-	
IP Rating	-	
Temp	Min: - Max: - °C Min: - Max: - °F	
EX Approvals	-	Please refer to instruction manual and certification documentation for product appropriate certification information
Display		
Digit size (upper/lower)		-mm/-mm
Accumulated total		×
Resettable total		×
Preset total		×
Flow rate		×
Outputs		
4-20 mA (passive)		×
Pulse/Transistor Output		×
Flow Alarm		×
Batch Control output		×

# PRODUCT DATA SHEET

WM80AAP-3C

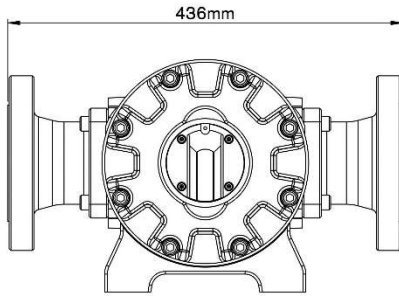
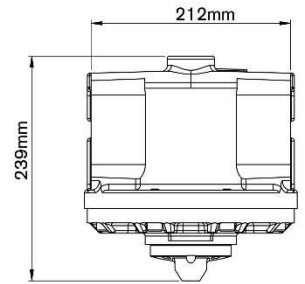
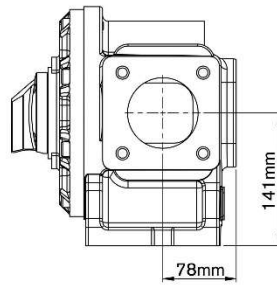
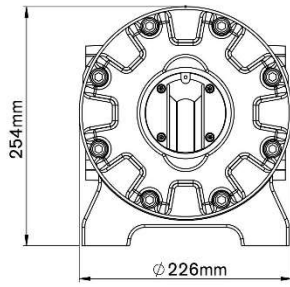

ANSI

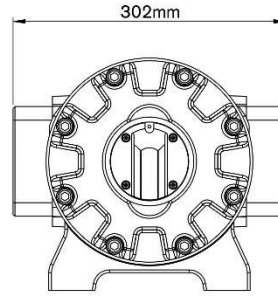

G/NPT